

# LED EXIT SIGN + EMERGENCY LIGHT COMBO

Code: ELCCOMBO2



The ELCCOMBO2-R series combines LED exit illumination with reliable LED lamp emergency lighting and energy efficiency for a maintenance-free, dependable design.



**Compatible Battery:** [BAA-36](#)

**Compatible Remote Head(s):** ELCRHP-L-3V, ELCRHB-WPL-3V, ELCRHP-L-3V

## ORDERING INFORMATION

Series	Letter Color	Housing Color	Operation Type	Options
ELCCOMBO2	R (Red)	W (White)	BB (Battery Backup)	3F (3' Cord)
	G (Green)		RH (Remote Head Capable)	
			ST (Self Testing)	

## FEATURES

- UL 924, NEC, OSHA and NFPA 101 Life Safety Code
- Listed for damp location
- All LED light! No SLA batteries, uses long lasting NiCads that are very low maintenance (battery included)
- Two fully adjustable, glare-free LED lighting heads
- Injection molded, 5VA flame retardant thermoplastic housing
- 120/277 VAC operation
- Universal mounting plate
- Knock-out left/right arrows
- Short circuit, voltage surge, brown out and low battery voltage disconnect protected
- LED indicator light with push-to-test switch

## WARRANTY INFORMATION

Any component that fails due to manufacturer's defect is guaranteed for 1 year. The warranty only covers products installed and maintained in accordance with the instructions provided by their respective manufacturer and no warranty is made with respect to any of our products that are otherwise installed or maintained. For full warranty details, visit our Warranty Section.

## Conformance to Codes and Standards

The ELCCOMBO2-R series is UL listed and meets or exceeds the following: UL 924, NEC, OSHA and NFPA 101 Life Safety Code requirements.

## CONSTRUCTION

The ELCCOMBO2-R series is constructed from injection-molded, high-impact, engineering-grade, 5VA flame retardant thermoplastic. White housing is standard.

## ILLUMINATION

Emergency lamps use long-lasting, energy efficient ultra bright white LEDs. Heads are made with high-performance chromeplated reflectors and polycarbonate lenses for optimal light distribution. Exit portion uses red or green LEDs.

## ELECTRICAL COMPONENTS

120/277 VAC operation. LED display indicates AC/ON. An external push button test switch allows maintenance personnel to quickly determine the operational status of the unit. Unit offers surge protected, solid state circuitry.

## EMERGENCY OPERATION

Upon failure of the normal utility power, an internal solidstate transfer switch automatically provides uninterrupted emergency operation for at least 90 minutes. The fully automatic solid-state, two-rate charger initiates recharging a discharged battery within 24 hours.

## BATTERY - BATTERY BACKUP

The ELCCOMBO2-R Combo Exit Light is designed with a maintenance-free 3.6V 100mAh NiCad battery that provides a minimum emergency duration of 90 minutes. Recharge time of the battery is 24 hours.

## PHOTOMETRICS

Standard mounting height of 7.5ft illuminates 1 footcandle (FC) **spaced at 18ft for a 3ft path of egress.**

Standard mounting height of 7.5ft illuminates 1 footcandle (FC) **spaced at 14ft for a 6ft path of egress.**

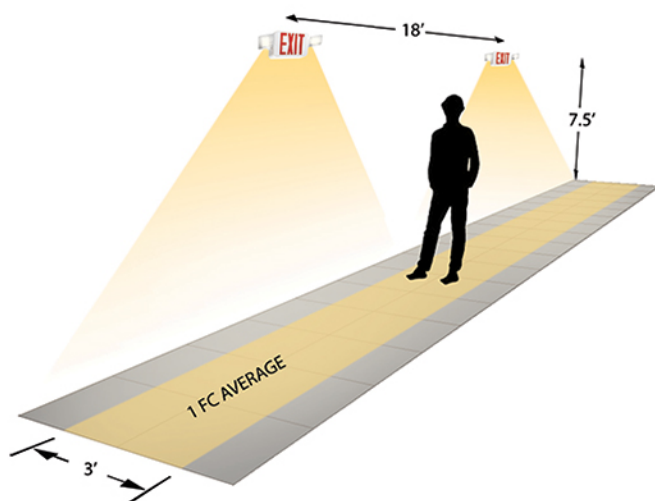

## SELF-TESTING OPTION

Unit continuously monitors the AC power, battery supply voltage, emergency lamp condition and charging circuit. If failure is detected, the indicator will show status and correct when adjusted. Unit will automatically perform testing for five minutes every 28 days and 90 minutes every six months.

## OPERATIONAL TEMPERATURE

### Temperature Ratings

Standard Option	20°C to 30°C / 68°F to 86°F
-----------------	-----------------------------

## REMOTE HEAD CAPABLE OPTION

The remote head capability option allows the ELCOMBO2 unit to supply power to up to two additional 3.6V LED remote heads. The remote heads would then operate on the same emergency mode as the standard units (see Emergency Operation Section).

## INSTALLATION

The ELCCOMBO2-R is suitable for surface wall and top mounting via included canopy. Snap together design allows for quick and easy installation. Knock-out chevrons for customized egress signage.

## DIMENSIONS

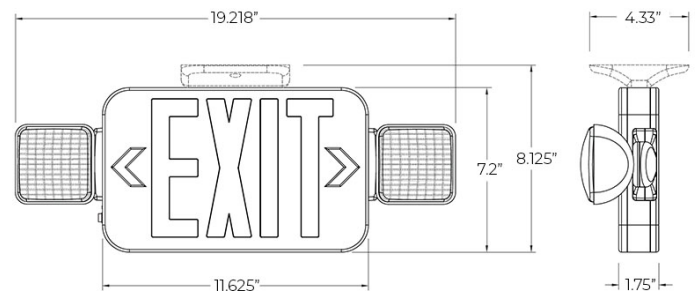

Weight : 8.00 lb