

Model: CA-U



IMPORTANT SAFEGUARDS

**WHEN USING ELECTRICAL EQUIPMENT,
BASIC SAFETY PRECAUTIONS SHOULD BE FOLLOWED INCLUDING THE FOLLOWING:**

- Installation and servicing to be performed only by qualified personnel.
- All electrical connections must be in accordance with local codes and ordinances.
- Turn off electrical power and allow the unit to cool off before opening for maintenance or servicing.
- Do not use outdoors.
- Do not let power supply cords touch hot surfaces.
- Do not use in hazardous locations or mount near gas or electric heaters.
- Use caution when servicing batteries, avoid possible shorting. Battery acid can cause burns to skin and eyes. If acid is spilled on skin or in eyes, flush acid with fresh water and contact a physician immediately (Not applicable to AC-only model).
- Equipment should be mounted in a location and at heights where it will not readily be subject to tampering by unauthorized personnel.
- The use of accessory equipment not recommend by the manufacturer may cause unsafe conditions.
- After installation, allow battery to recharge for 24 hours before the first full duration discharging test.
- Do not use this equipment for other than its intended use.

WIRING DIAGRAM

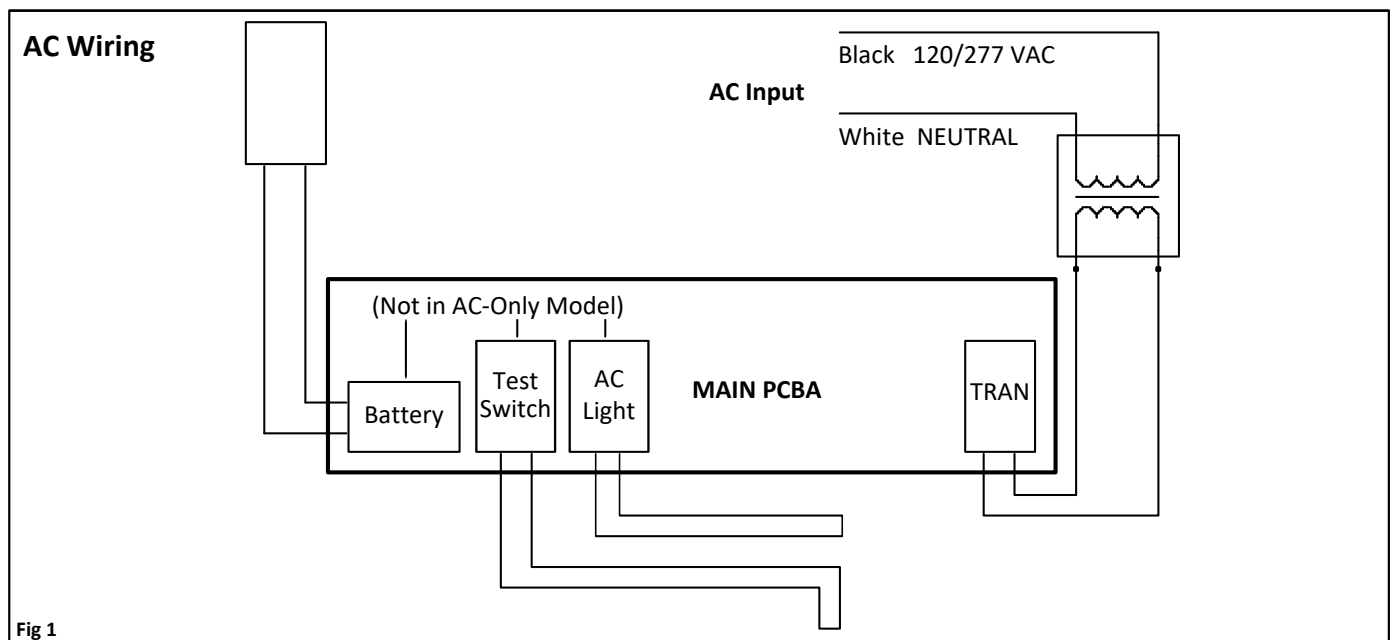

INSTALLATION INSTRUCTIONS

Wall, End and Ceiling Mount

1. Start by removing front cover from main housing (Fig 2).
2. Change color of sign if necessary (Fig 3).
3. Change product function if necessary (Fig 4).
4. Remove mounting, conduit and chevron knockouts as needed (Fig 5). **CAUTION:** Carefully remove the knockouts so as not to cause damage to the surface

5. End and Ceiling mount only:

- a. FOR DOUBLE FACE; Remove the back plate from the housing by removing housing screws (4pcs) at the corner of the Exit housing. Then assemble the additional EXIT panel using the housing screws (4pcs) with the housing.
(NOTE: The additional EXIT panel does not have any clips)
 - b. Attach crossbar to junction box (Fig 7, 8). Secure canopy to the housing using hole numbers "2" and "3" on the canopy with provided canopy screws ((2) # 10-24 screws).
6. Feed fixture leads into junction box and connect AC power supply wires according to wiring diagram (Fig 1). Cap off any unused wires.
 7. Using screws supplied, attach fixture to junction box (Fig 6, 7, and 8).
 8. Apply continuous AC power.
 9. Connect battery only after continuous AC power is provided to the unit (Fig 1). (**Not applicable to AC-only model**)

Opening Exit Sign

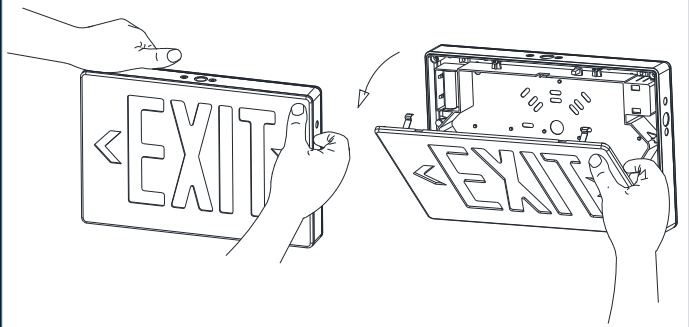

Fig 2

Selecting Red Or Green

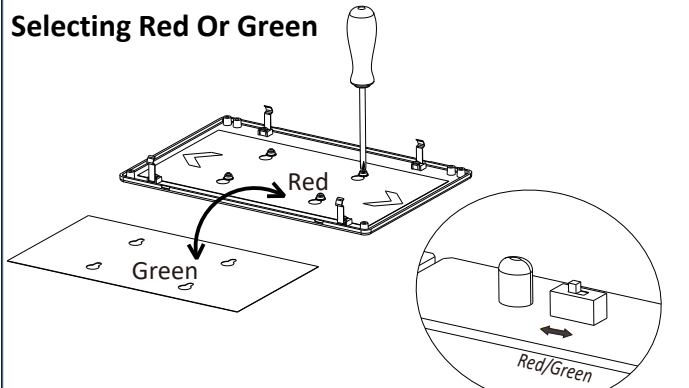

Fig 3

Selecting Manual Test, AC Only, Or Self-Testing

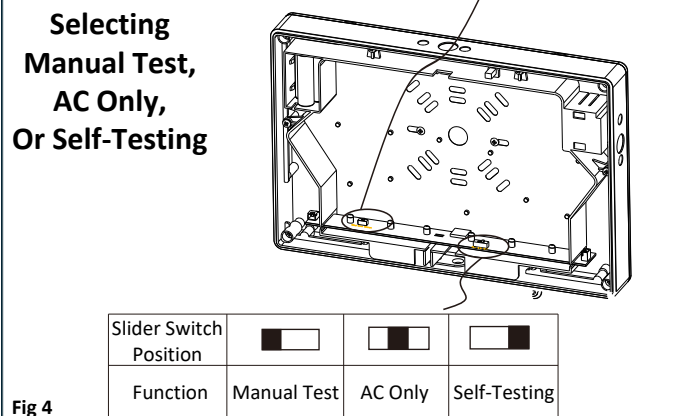

Fig 4

Removing Mounting, Conduit, and Chevron Knockouts

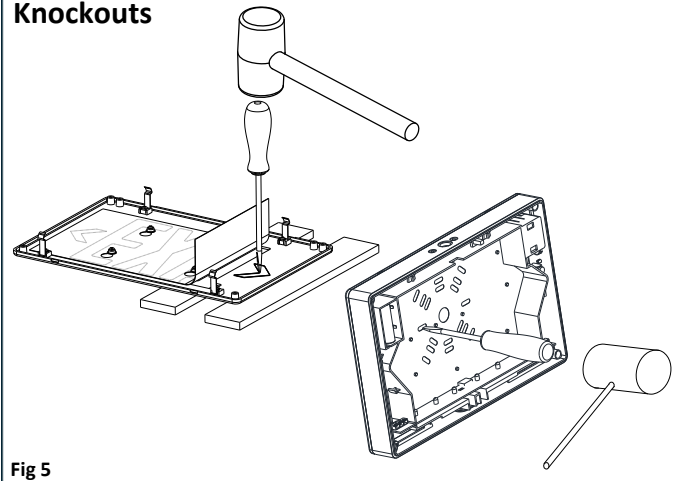

Fig 5

INSTALLATION INSTRUCTIONS

Wall Mount Parts List:

1. Housing
2. EXIT Panel
3. Back Plate
4. Red or Green Diffuser
5. Housing Screws
6. Wire Nuts
7. Junction Box (Not Provided)
8. Crossbar Screws (Not Provided)
9. Battery (Not Provided with AC only model)

Wall Mount

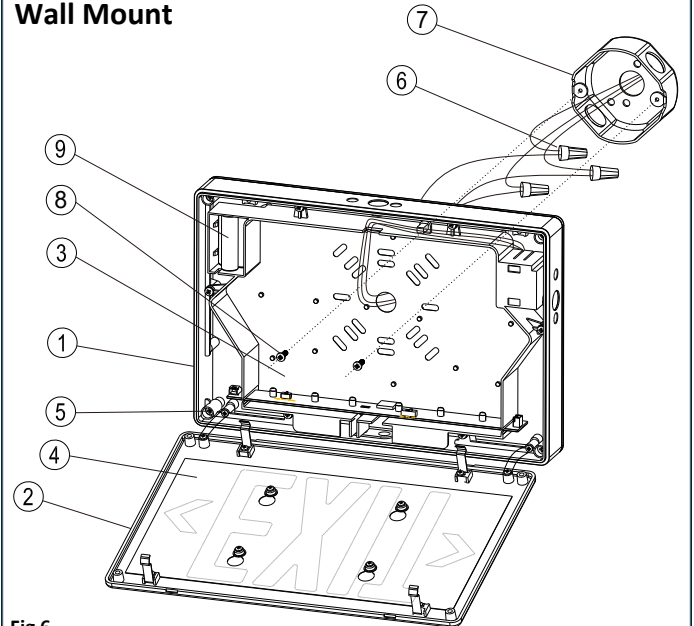

Fig 6

End Mount Parts List:

1. Housing
2. EXIT Panel
3. Back Plate
4. Red or Green Diffuser
5. Housing Screws
6. Canopy
7. Canopy Screws
8. Crossbar
9. Wire Nuts
10. Junction Box (Not Provided)
11. Crossbar Screws (Not Provided)
12. Battery (Not Provided with AC only model)

End Mount

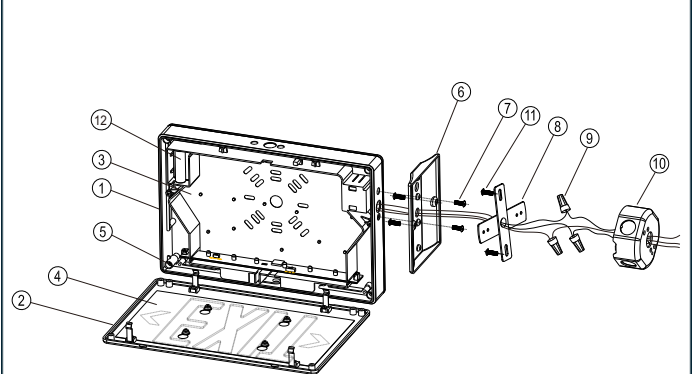

Fig 7

Ceiling Mount Parts List:

1. Housing
2. EXIT Panel
3. Back Plate
4. Red or Green Diffuser
5. Housing Screws
6. Canopy
7. Canopy Screws
8. Crossbar
9. Wire Nuts
10. Junction Box (Not Provided)
11. Crossbar Screws (Not Provided)
12. Battery (Not Provided with AC only model)

Ceiling Mount

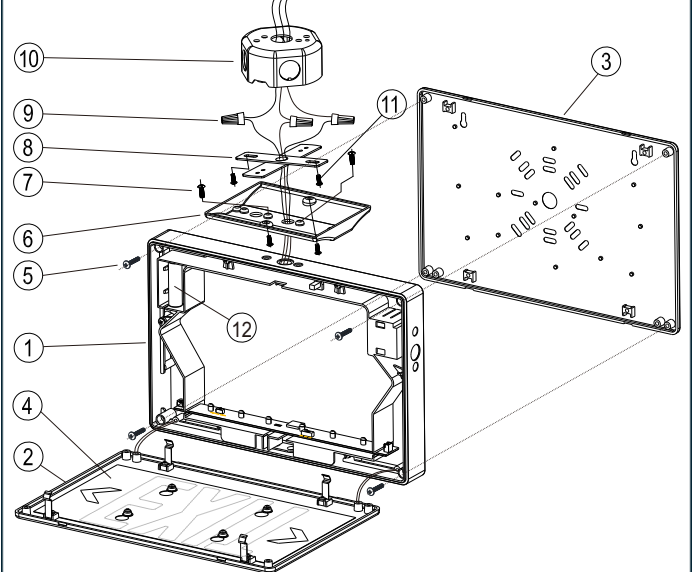

Fig 8

OPERATION

Normal Mode - AC power is present.

Emergency Mode - Normal AC power fails. LED lamps will be illuminated for a minimum of 90 minutes via battery or generator backup. When normal AC power is restored, the system returns to Normal Mode and if equipped with battery resumes charging.

TESTING AND MAINTENANCE

(For **AC-only model** testing and maintenance, see note below in parenthesis)

Pressing the external test button simulates an AC power failure and forces the system into Emergency Mode. The LED lamps will illuminate. Testing may also be performed by turning off the corresponding circuit breaker.

Initial Test - Allow the unit to charge for 1 hour, then press the test button to conduct a short test. Allow a 24 hour charge before conducting a 90 minute test.

Monthly Test - Ensure that the test button is illuminated. Conduct a 30 second test by depressing the test button.

Annual Test - Ensure that the test button is illuminated. Conduct a 90 minute test by turning off the corresponding circuit breaker.

(When using an **AC-only model** that relies on a generator or other means to provide emergency power, the same initial, monthly and annual tests must be performed by simulating normal AC power loss to the device being tested. Verify that the emergency power source provides power to the device for the durations of time listed above for each corresponding test.)

Written records of testing shall be kept on file for inspection by the authority having jurisdiction.