

Model: ELR-RG



IMPORTANT SAFEGUARDS

**WHEN USING ELECTRICAL EQUIPMENT,
BASIC SAFETY PRECAUTIONS SHOULD BE FOLLOWED INCLUDING THE FOLLOWING:**

- Installation is to be performed only by qualified personnel.
- All electrical connections must be in accordance with local codes and ordinances.
- Turn off electrical power and allow the unit to cool off before opening for maintenance or servicing.
- Suitable for damp locations. Do not use outdoors.
- Do not let power supply cords touch hot surfaces.
- Do not use in hazardous location or mount near gas or electric heaters.
- Use caution when servicing batteries. Battery acid can cause burns to skin and eyes. If acid is spilled on skin or in eyes, flush acid with fresh water and contact a physician immediately.
- Equipment should be mounted in location and at heights where it will not readily be subject to tampering by unauthorized personnel.
- The use of accessory equipment not recommend by the manufacturer may cause unsafe conditions.
- After installation, allow battery to recharge for 24 hours before the first full duration discharging test. .
- Do not use this equipment for other than intended use.
- All servicing should be performed by qualified personnel only.

WIRING DIAGRAM

Use Flexible Conduit Only

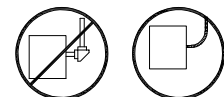

AC Wiring

Connect the white wire to the neutral lead.
Connect the black wire to the hot lead.

AC Input

Orange 277VAC

Black 120VAC

White NEUTRAL

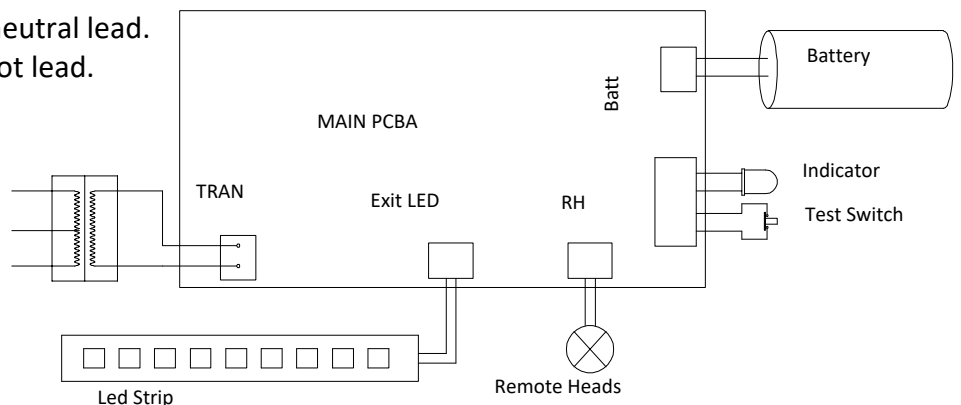

Fig. 1

RECESSED, CEILING & WALL MOUNT

NOTICE: WEAR GLOVES

1. Install recessed kits between joists. Position recessed kits temporarily by hammering "nail-in" tabs on bar hangers, then secure permanently with nails or screws. Bar hangers should be level with bottom of joists. Adjust height of recessed kits vertically using adjusting slots and then tightening all screws on adjusting slots and bar hanger bracket to secure adjusting bracket and bar hangers.
2. Separate trim plate, connect battery connector as shown in wiring diagram.
3. Hang safety cable from the module clip (see Fig 4)
4. Remove J-Box Cover, Route the wires into the J-Box.
5. Make electrical connections according to wiring diagram.
6. Push excess wire into J-Box, install J-Box cover.
7. Assemble trim plate back using M3*15mm screws.
8. Connect light bar connector, assemble panel module to trim plate.

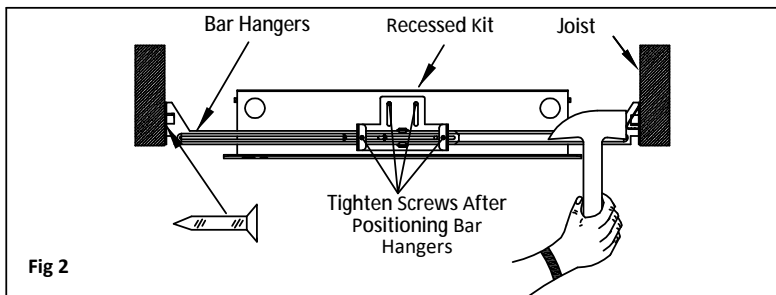

Fig 2

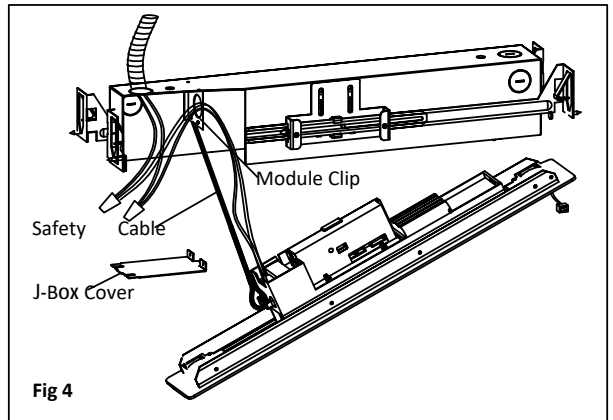
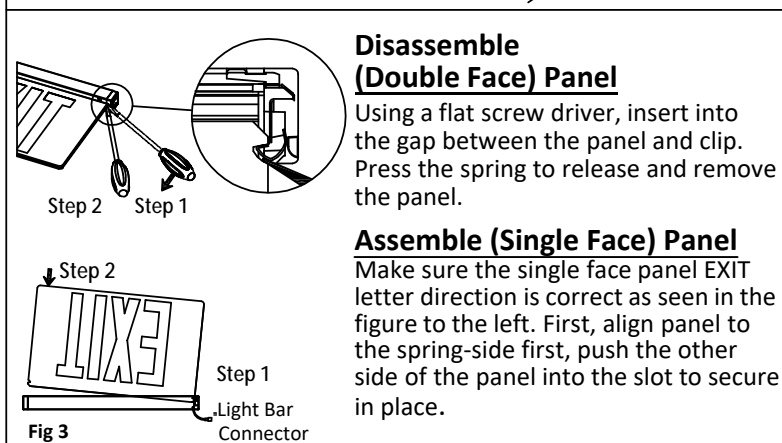

Fig 4

Recessed Wall Mount

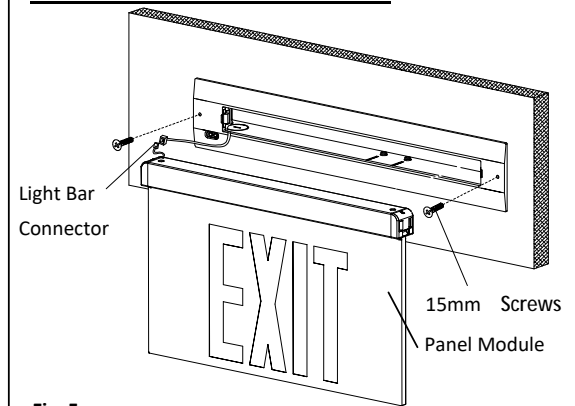

Fig. 5

Recessed Ceiling Mount

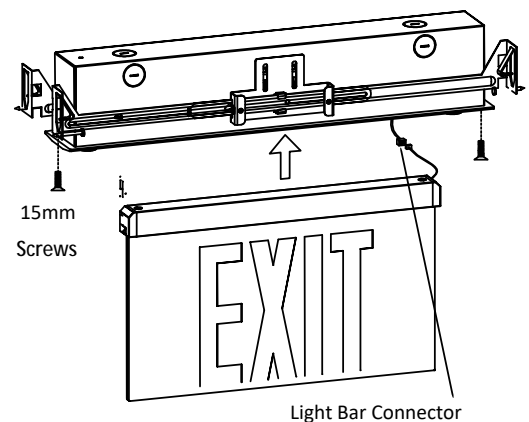

Fig 6