

## Model: LEDSW



### IMPORTANT SAFEGUARDS

**WHEN USING ELECTRICAL EQUIPMENT,  
BASIC SAFETY PRECAUTIONS SHOULD BE FOLLOWED INCLUDING THE FOLLOWING:**

- Installation is to be performed only by qualified personnel.
- All electrical connections must be in accordance with local codes and ordinances.
- Turn off electrical power and allow the unit to cool off before opening for maintenance or servicing.
- Suitable for damp locations. Do not use outdoors.
- Do not let power supply cords touch hot surfaces.
- Do not use in hazardous location or mount near gas or electric heaters.
- Use caution when servicing batteries. Battery acid can cause burns to skin and eyes. If acid is spilled on skin or in eyes, flush acid with fresh water and contact a physician immediately.
- Equipment should be mounted in location and at heights where it will not readily be subject to tampering by unauthorized personnel.
- The use of accessory equipment not recommend by the manufacturer may cause unsafe conditions.
- After installation, allow battery to recharge for 24 hours before the first full duration discharging test. .
- Do not use this equipment for other than intended use.
- All servicing should be performed by qualified personnel only.

### WIRING DIAGRAM

Use Flexible Conduit Only

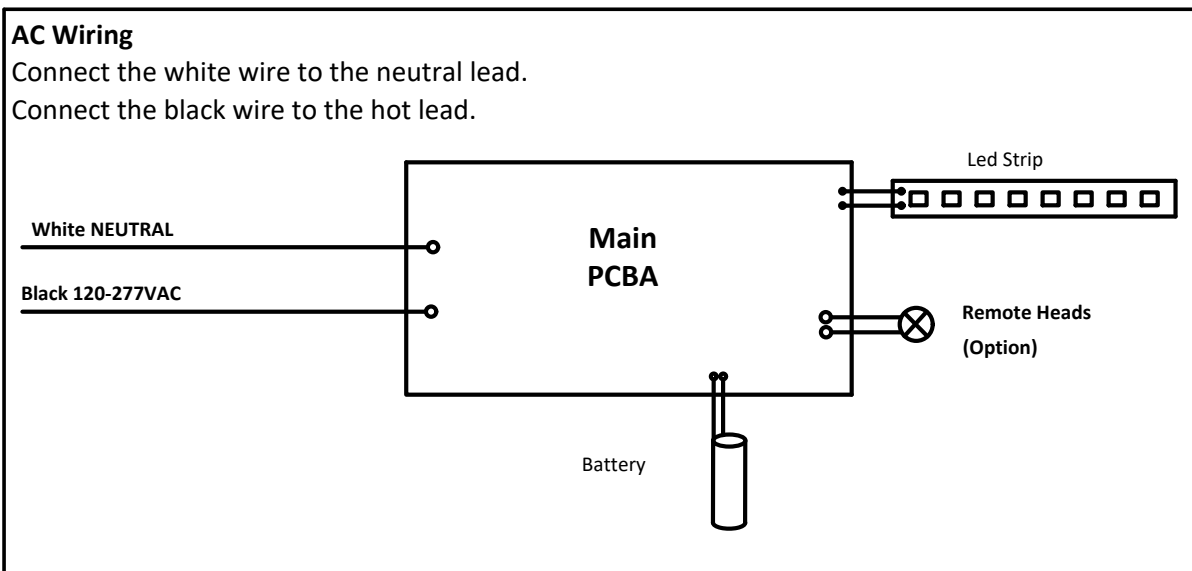
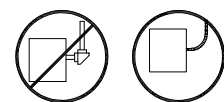

## Surface, Ceiling & Wall Mount

### NOTE: First Turn Off Electricity

1. Attach the crossbar to the junction box.
2. Remove fixed set screws, then remove the mounting bracket.

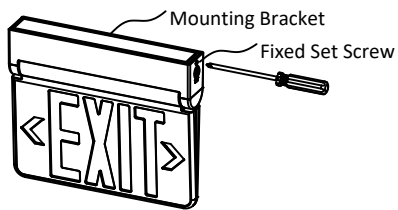

3. Knock out mounting and cable entry holes on the **top** of mounting bracket.
4. Feed AC wires through the center hole of mounting bracket. Make wire connections (Refer to Wiring Diagram on Page 1).
5. Assemble canopy onto mounting bracket with (2) PM4-12 screws and (2) M4 nuts.
6. Use (2) PM4-40 screws to tighten canopy to junction box crossbar.

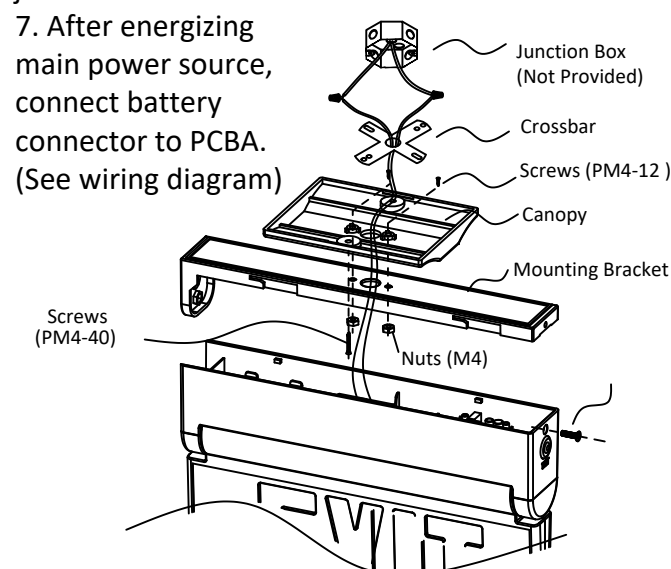

8. Assemble housing on the mounting bracket, slide up first, then slide to the left, then screw in the fixing screw.

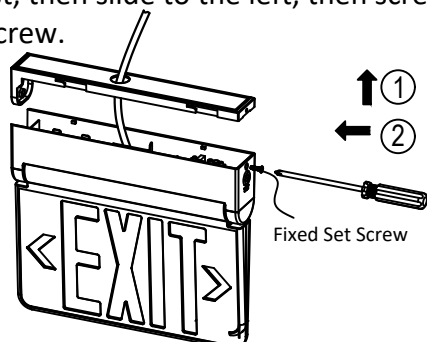

9. Snap chevron arrows on the exit panel if needed.

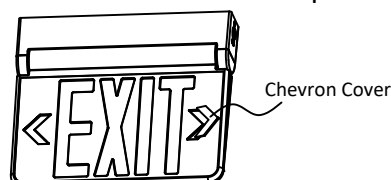

10. If the fixture needs to be single-sided, assemble the back panel onto the fixture.

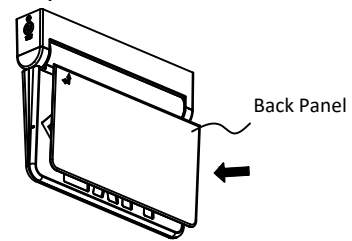

11. The exit panel swings freely, adjust as needed for different angles and mounting configurations.

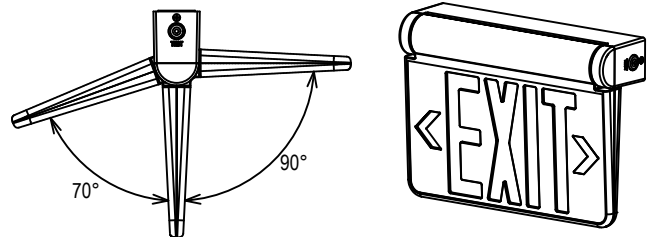

## Side Mount

1. Attach the crossbar to the junction box.
2. Remove fixed set screws, then remove the mounting bracket.
3. Knock out mounting and cable entry holes on the **side** of mounting bracket.
4. See steps 4 - 11 in **Surface, Ceiling & Wall Mount** above for the remainder of Side Mount installation.

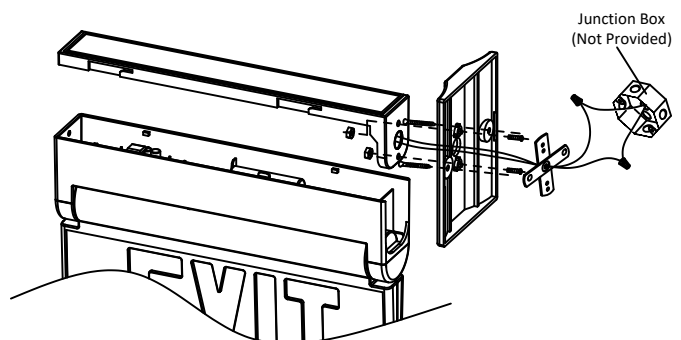

## Connecting Remote Heads (Optional)

Optional accessory on RH model with remote head capability.

Maximum remote capability; 6V 1.5W.

Attach remote head cable to remote head connector on PCBA. Remote head cable has 2 wires; yellow is positive(+), blue is negative(-). Connect wires using wire nuts.

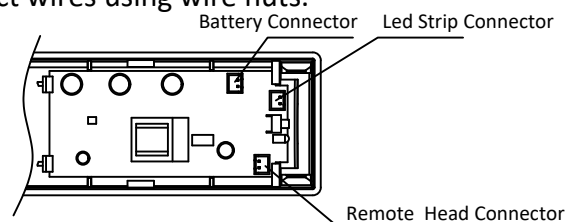

## **MAINTENANCE**

If the product is stored for over 12 months, the battery will require charging. We recommend testing the equipment regularly in accordance with local codes. Replace the batteries if discharge time does not meet the required 90 minutes.

## **OPERATION**

Press the test button to activate the unit, which will then power the sign by the battery backup, and the LED indicator will turn off. Release the test button, and the LED indicator will turn back on returning to normal operation.

## **TROUBLE SHOOTING GUIDE**

If LED array or LED indicator does not illuminate, check the following:

1. Check AC supply - Verify that the unit has constant 24-hour AC supply.
2. Battery connection - Verify the battery is connected properly.
3. Discharge battery and charge for 24-hour and then re-test.
4. If the above troubleshooting does not solve the problem, please contact us for assistance.